

2
3 RESOLUTION NO. F2008-23

4 **SETTING A PUBLIC HEARING DATE FOR PALM SPRINGS MDP LINE 41,**
5 **STAGE 3 AND GIVING NOTICE OF INTENT TO ADOPT A SUBSEQUENT**
6 **MITIGATED NEGATIVE DECLARATION THEREFORE IN ACCORDANCE**
7 **WITH THE CALIFORNIA ENVIRONMENTAL QUALITY ACT (CEQA)**

8 WHEREAS, this Board intends to undertake a project in Riverside County, within the City of
9 Palm Springs, California, designated as Palm Springs Master Drainage Plan (MDP) Line 41, Stage 3; and

10 WHEREAS, the proposed project is bounded generally by East Palm Canyon Drive toward the
11 north, the San Jacinto Mountains toward the south and west, and Golf Club Drive toward the east; and

12 WHEREAS, the proposed project consists of constructing and maintaining an approximate 6.7
13 acre detention basin and an underground storm drain system; and

14 WHEREAS, reference is made to the engineering estimate of the cost of the proposed project,
15 entitled "Engineer's Statement" on file with the Clerk of this Board; and

16 WHEREAS, reference is made to a map dated December 2005, bearing the name and showing the
17 general location and typical section of the proposed project which is also on file with the Clerk of this
18 Board; and

19 WHEREAS, a Subsequent Mitigated Negative Declaration was prepared in response to new
20 information regarding potential impacts to biological resources (i.e. Casey's June beetle); and

21 WHEREAS, the original Mitigated Negative Declaration adequately addressed all impacts except
22 the Casey's June beetle; and

23 WHEREAS, the General Manager-Chief Engineer of the District has found that the proposed
24 project will not have a significant effect on the environment and has prepared a Subsequent Mitigated
25 Negative Declaration which will not become final until adopted by this Board; and

26 WHEREAS, any person wishing to comment on the Subsequent Mitigated Negative Declaration
27 may do so in writing between the date of this notice and the public hearing, or may appear and be heard at
28 the time and place noted below; and

///

1 WHEREAS, in a subsequent legal challenge any person may be limited to raising only those
2 issues he, she or someone else raised at the public hearing described in this notice, or in written comments
3 delivered before or at the public hearing; and

4 WHEREAS, prior to making a decision on the proposed project or the Subsequent Mitigated
5 Negative Declaration, this Board will consider all written and oral comments; and

6 WHEREAS, the above-listed documents can be inspected at the District office, 1995 Market
7 Street, Riverside, California 92501 and written comments will be received at the above address.

8 NOW, THEREFORE, BE IT RESOLVED, DETERMINED AND ORDERED by the Board of
9 Supervisors of the Riverside County Flood Control and Water Conservation District in regular session
10 assembled on July 15, 2008 that:

11 1. A public hearing concerning the Subsequent Mitigated Negative Declaration will be held at
12 1:30 p.m. on September 16, 2008, in the meeting room of this Board, 1st Floor, County Administrative
13 Center, 4080 Lemon Street, Riverside, California, at which time all public comment shall be heard.

14 2. A copy of this Resolution and copies of the above-listed documents shall be posted at least
15 30 days before said hearing at City of Palm Springs, City Hall, 3200 E. Tahquitz Canyon Way, Palm
16 Springs, CA 92262.

17 3. A copy of this Resolution shall be posted at least 30 days before said hearing at the
18 Riverside County Clerk and Recorder's Office, 2724 Gateway Drive, Riverside, California 92507.

19 4. The Clerk of this Board is directed to cause a copy of this Resolution to be published once,
20 at least 30 days before said hearing, in a newspaper of general circulation in accordance with CEQA.

21 ROLL CALL:

22 Ayes: Buster, Stone, Wilson and Ashley
23 Nays: None
24 Absent: Tavaglione

25 The foregoing is certified to be a true copy of a
26 resolution duly adopted by said Board of Super-
27 visors on the date therein set forth.

28 NANCY ROMERO Clerk of said Board

By: *Nancy Romero* Deputy

27 KAL:ay
07/03/08

28 G:\Property\KLIND\PS Line 41 Subsequent MND 1st Resolution.doc

FORM APPROVED COUNTY COUNSEL

BY: *Katherine A. Lind* 07/03/08
KATHERINE A. LIND DATE

**Riverside County Flood Control
and Water Conservation District**

ENGINEER'S STATEMENT

**Palm Springs MDP Line 41, Stage 3
Project No. 6-0-0160
January 2006**

The proposed Palm Springs Master Drainage Plan (MDP) Line 41, Stage 3 project will consist of the construction and maintenance of a storm drain in Golf Club Drive, an earthen 6.7 acre detention basin and approximately 6,000 linear feet of an underground reinforced concrete pipe storm drain ranging from 66 to 96 inches in diameter. The proposed storm drain facility will begin at the terminus of the existing Palm Springs MDP Line 41, Stage 2 inlet and generally extend in a westerly direction along East Palm Canyon Drive, Gene Autry Trail, Matthew Drive, Cherokee Way, and Santa Monica Drive. The proposed storm drain will extend westerly, for approximately 100-feet, past the intersection of Carmel Drive and Santa Monica Drive and terminate with a concrete lined inlet structure. The proposed project also includes the construction of lateral storm drains along Linden Drive and along the southerly extension of the unimproved Cherokee Way. These laterals will total approximately 1,000 feet in length and range in size from 36 to 48 inches in diameter. Additional capacity will also be provided at Golf Club Drive by increasing the size of the existing storm drain under Golf Club Drive and reconstructing the concrete lined inlet structure just to the north of Palm Canyon Drive. The project will be designed to convey the estimated 100-year flow rate. The proposed project is generally bounded by East Palm Canyon Drive toward the north, the San Jacinto mountains toward the south and west, and Golf Club Drive toward the east in the city of Palm Springs. Township 4 South, Range 5 East, Sections 29-30, Palm Springs and Cathedral City, California 7.5' USGS Quad Sheets.

The purpose of the proposed project is to collect the 100-year tributary storm flows and convey them to the existing Palm Springs MDP Line 41 Stage 2 facility near Golf Club Drive. The estimated cost of the proposed project is \$9.8 Million. Construction and future operation and maintenance costs will be borne by the District's Zone 6 revenue. The Cities of Palm Springs and Cathedral City are also expected to fund a portion of the project cost.

A map of the project depicting the project location and typical section is attached. Additional information may be obtained from Riverside County Flood Control and Water Conservation District, 1995 Market Street, Riverside, California 92501, 951.955.1200.

Attachment

RS:mcv

END PROJECT

SECTION 18 PUBLIC HEARING MAP

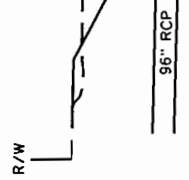
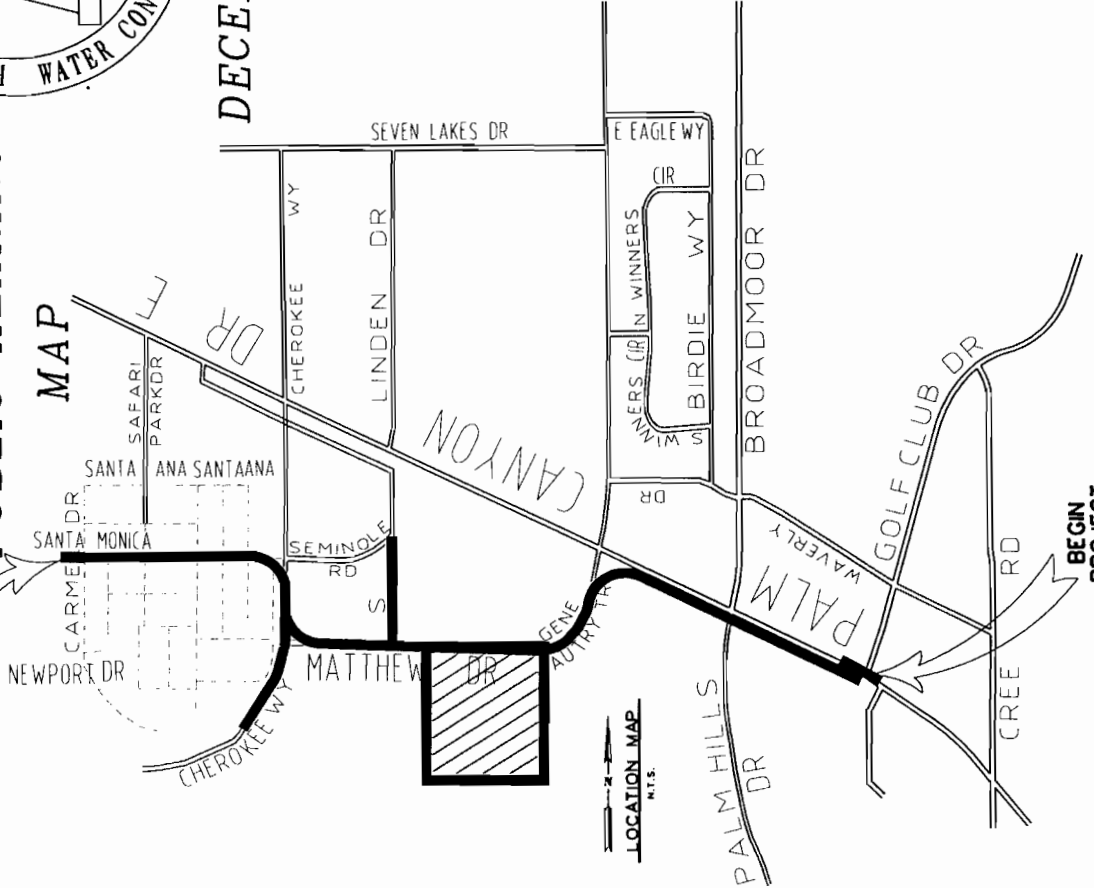

CROSS SECTION EARLHEN BASIN
NTS



PALM SPRINGS MDP LINE 41 STAGE 3 PROJECT NO. 6-0-0160

DECEMBER 2005

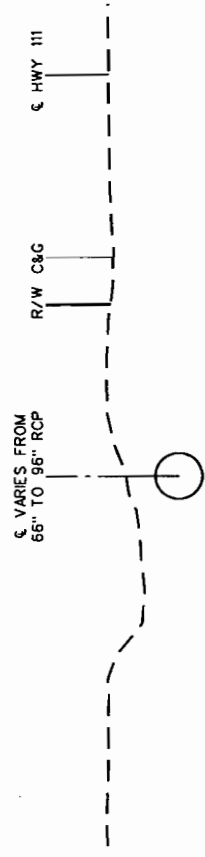
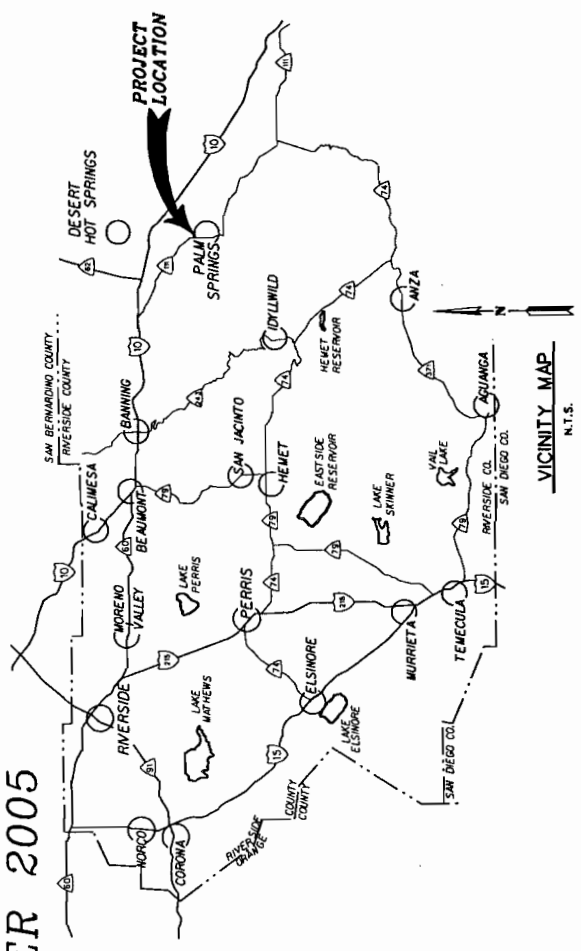

TYPICAL CROSS SECTION
NTS

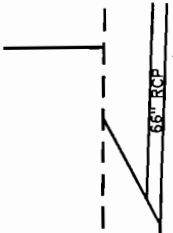

CROSS SECTION EARLHEN BASIN
NTS